

TERMINAL LEAD DETAIL

REVISIONS				
CHANGE ORDER	LTR	DESCRIPTION	DATE	APPROVED
ENG	1	PAG 46 was PAG 100, ADDED: 'QP-H100'	10/01/08	
Q09035	2	ADDED TOLERANCES & PART NO'S	10/14/09	
INSP	3	APPRX 265 WAS APPRDX 246	03/29/11	

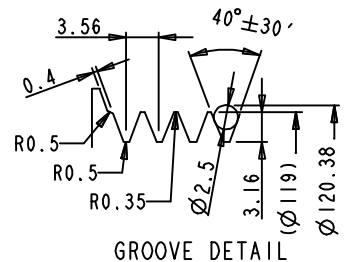
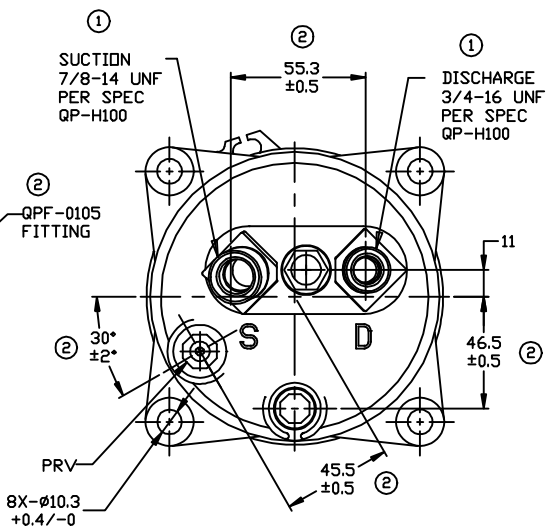
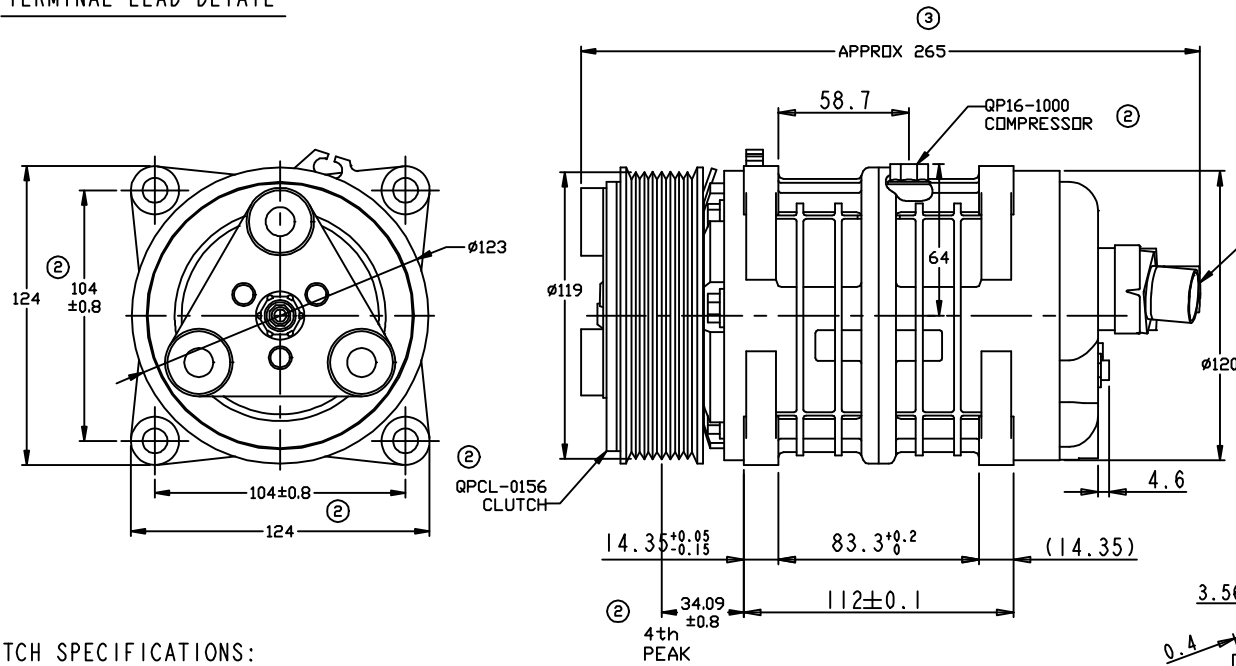

- CLUTCH SPECIFICATIONS:**
- VOLTAGE..... 24 VDC
  - BELT..... PV8
  - STATIC TORQUE  
INITIAL..... 35 Nm (3.5 Kgfm)  
AFTER BURNISHING..... 49 Nm (5 Kgfm)
  - MAX POWER CONSUMPTION..... 45W @ 25°C
  - ROTATION DIRECTION..... CW OR CCW
  - WEIGHT..... 2.30 Kg

- COMPRESSOR SPECIFICATIONS:**
- MODEL..... QP16HD
  - NUMBER OF CYLINDERS..... 6
  - BORE X STROKE..... 36 X 26.7 mm
  - DISPLACEMENT..... 162.9 cm<sup>3</sup>/REV
  - SPEED RANGE..... 700 - 6000 RPM
  - ROTATION DIRECTION..... CW OR CCW
  - REFRIGERANT..... R-134a
  - LUBRICANT..... PAG 46 180+20 cm<sup>3</sup>
  - WEIGHT..... 4.7 Kg

UNLESS OTHERWISE SPECIFIED DIMENSIONS ARE IN MM. INTERPRET DIM AND TOL PER ASME Y14.5M - 1994		CAD GENERATED DRAWING, DO NOT MANUALLY UPDATE		 DECATUR, ILLINOIS	
THIRD ANGLE PROJECTION		DRAWN GLB	DATE 06/21/07		
		CHECKED		SIZE A	CODE IDENT NO
		APPROVED		DWG NO	REV 3
FINISH		ENG APPVL		QP16-1352	
SCALE NONE				SHEET 1 OF 1	