

REVISIONS				
CHANGE ORDER	LTR	DESCRIPTION	DATE	APPROVED
Q09035	1	ADDED TOLERANCES & PART NO'S	09/25/09	

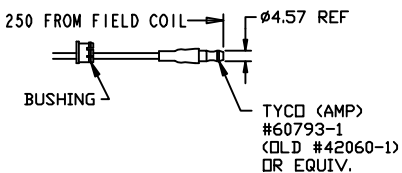

TERMINAL LEAD DETAIL

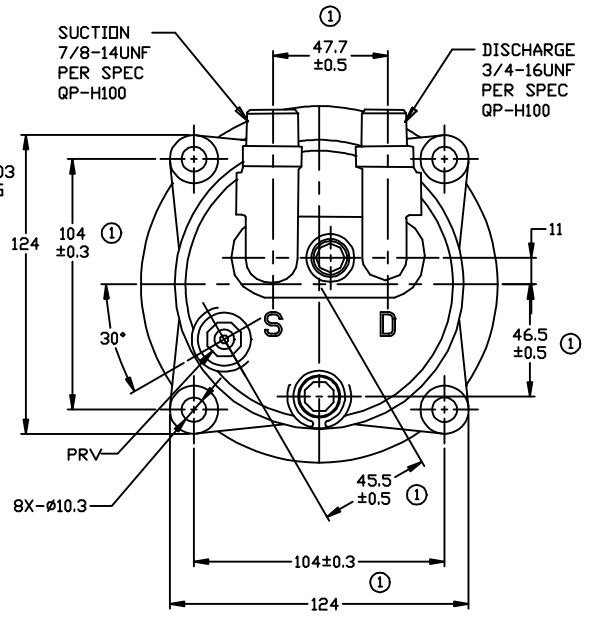
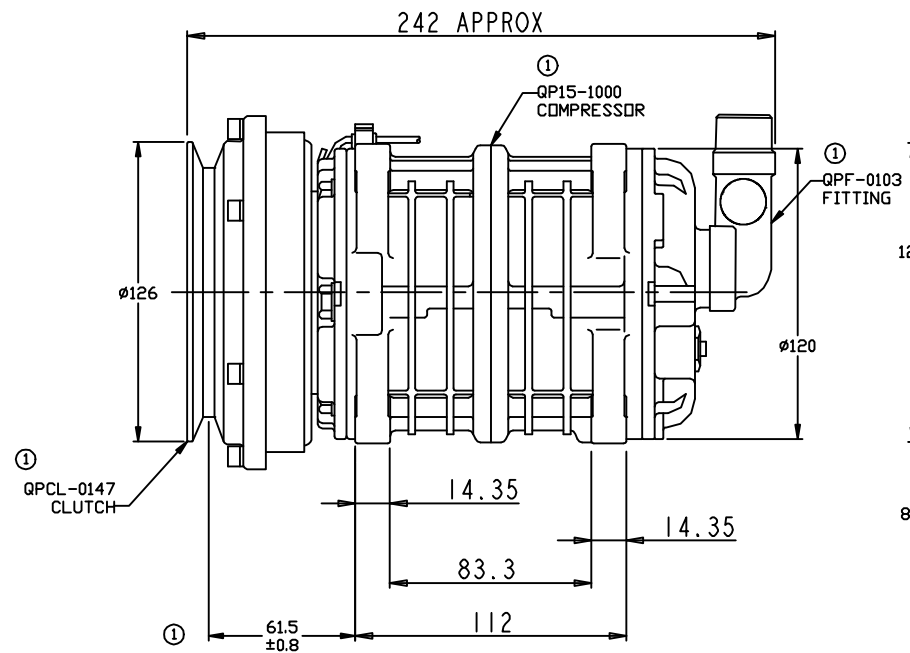
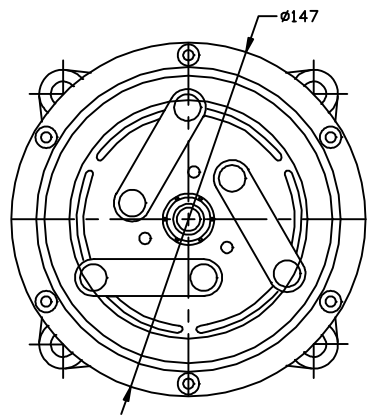

- CLUTCH SPECIFICATIONS:**
- VOLTAGE..... 12 VDC
 - BELT..... .A1
 - STATIC TORQUE
INITIAL..... 35 Nm (3.5 Kgf)
AFTER BURNISHING..... 49 Nm (5 Kgf)
 - MAX POWER CONSUMPTION..... 45W @ 25°C
 - ROTATION DIRECTION..... CW OR CCW
 - WEIGHT..... 2.3 Kg

- COMPRESSOR SPECIFICATIONS:**
- MODEL..... QP15HD
 - NUMBER OF CYLINDERS..... 6
 - BORE X STROKE..... 36 X 24.0 mm
 - DISPLACEMENT..... 146.7 cm³/REV
 - SPEED RANGE..... 700 - 6000 RPM
 - ROTATION DIRECTION..... CW OR CCW
 - REFRIGERANT..... R-134a
 - LUBRICANT..... PAG 46 150+20 cm³
 - WEIGHT..... 4.4 Kg

UNLESS OTHERWISE SPECIFIED DIMENSIONS ARE IN MM. INTERPRET DIM AND TOL PER ASME Y14.5M - 1994	CAD GENERATED DRAWING, DO NOT MANUALLY UPDATE	
	DRAWN	DATE
	GLB	06/26/08
	CHECKED	
THIRD ANGLE PROJECTION	APPROVED	
	ENG APPVL	
FINISH		

QUE PRODUCTS, LLC
 DECATUR, ILLINOIS

TITLE: COMPRESSOR ASSEMBLY
 QP15HD V-3/4 7/8
 A1 126mm OVER-HANG 12V

SIZE A	CODE IDENT NO	DWG NO QP15-1166	REV 1
SCALE NONE		SHEET 1 OF 1	